

SX Nozzle

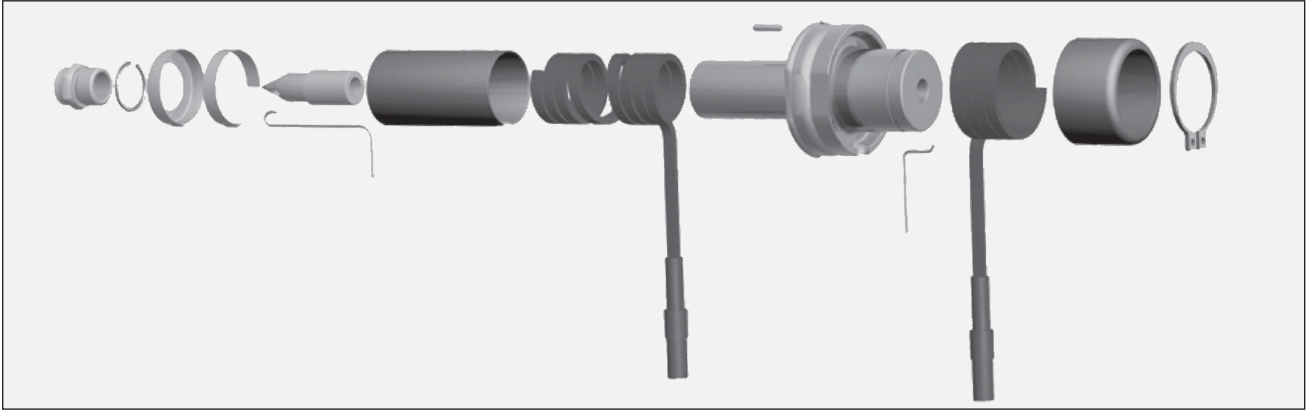

	Availability			
	13 Series	16 Series	19 Series	27 Series
L	45		—	
	55		—	
	65		—	
	75		—	
	95		—	
	115		—	
	—		145	
	—		175	
	—		225	
	—		275	
L4	18	20	25	
L5	44	46	50	
d2	40	50		

All measurements are in millimeters

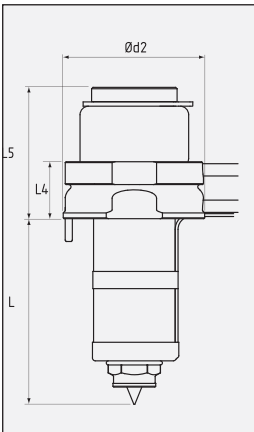
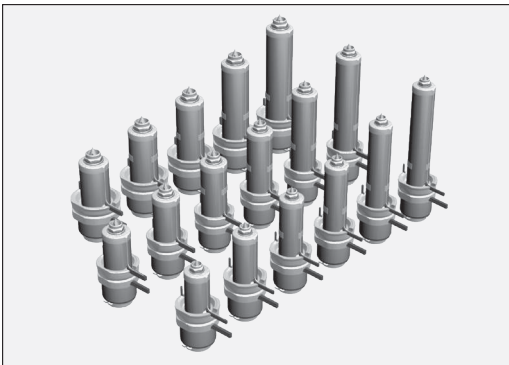

Overview and Applications

With two heaters the SX nozzle is perfectly suited for all single nozzle applications. Independently controlled heater zones provide uniform temperature distribution along the length of the nozzle, making it ideal to process difficult plastics.

Features

Mould Design

- Ability to easily order special length nozzles
- Shares the same gate profiles as MX and BX
- Consistent nozzle lengths across the range
- Ability to mould large parts with smaller nozzles due to optimum flow characteristics

Operation

- Separate heater for the nozzle head for maximum temperature control
- Wide moulding window
- Excellent temperature profile and thermal stability
- Operates at low moulding pressure and temperature
- Optimum cycle times due to superior thermal insulation
- Uses economical and robust coil heaters

Installation and Maintenance

- Simple machining and installation requirements
- Improved reliability due to the use of advanced material
- Common tip and nut options provide ready availability of spare parts

Gating Options

	Multi-Hole Torpedo Tip	One-Hole Torpedo Tip	Open Tip	Extended Tip
Open Nut				
Bush Nut				
Sprue Nut				