

HOT RUNNER & CONTROL

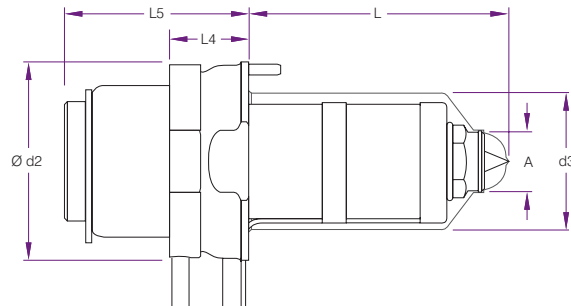

mastip™
hot runner solutions



With two heaters the SX nozzle is perfectly suited for all single nozzle applications. Independently controlled heater zones provide uniform temperature distribution along the length of the nozzle, making it ideal to process difficult plastics.

Gating Options

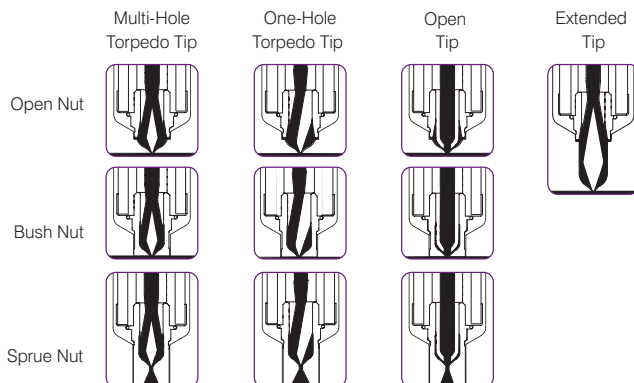

	13 Series	16 Series	19 Series	27 Series
L	45	45		
	55	55	55	
	65	65	65	
	75	75	75	75
	95	95	95	95
	115	115	115	115
			145	145
			175	175
				225
L4	18	18	20	25
L5	44	44	46	50
d2	40	40	50	50
d3	27	30	33	43
A	10	12	15	23

All measurements are in millimetres

mastip™
hot runner solutions

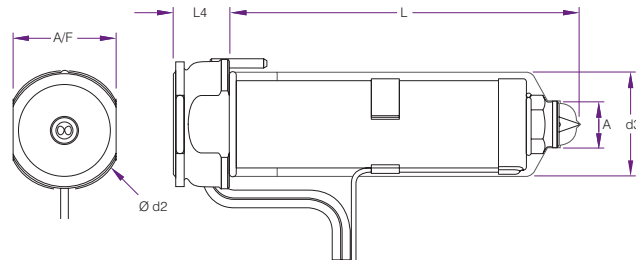

Low moulding temperature and pressure, excellent temperature consistency and front loading capabilities, that's the Mastip MX nozzle, specifically designed for multi cavity manifold systems and hot halves. The MX nozzle is suited for small to medium applications in all types of markets. It is able to process a wide range of plastics, from the easy ethylenes to tough engineering resins.

Gating Options

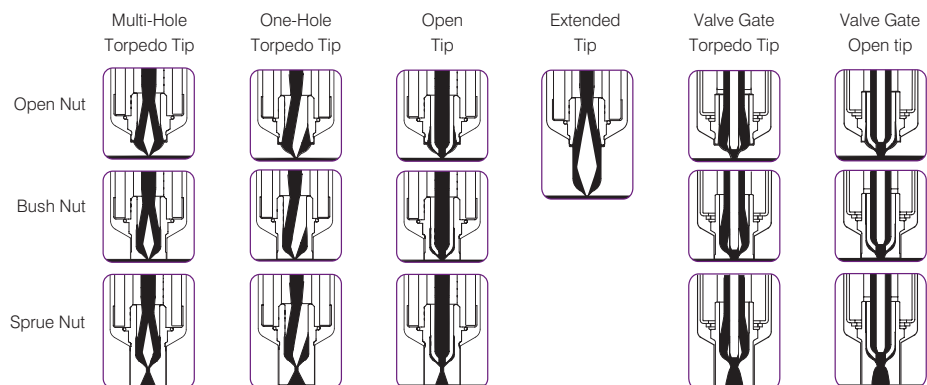

	13 Series	16 Series	19 Series
L	45	45	
	55	55	55
	65	65	65
	75	75	75
	95	95	95
	115	115	115
	145	145	145
	175	175	175
A/F	24	26	36
d2	28	30	40
d3	22.9	24.9	31.5
L4	12	12	15
A	10	12	15

All measurements are in millimetres

mastip™
hot runner solutions

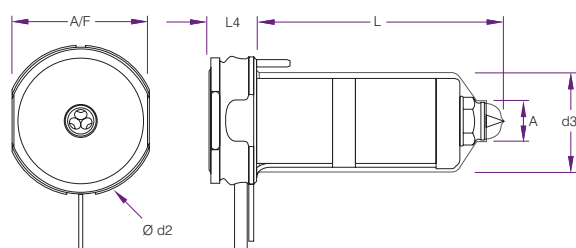

BX nozzle is designed to provide a cost sensitive solution to single & multicavity applications.

Gating Options

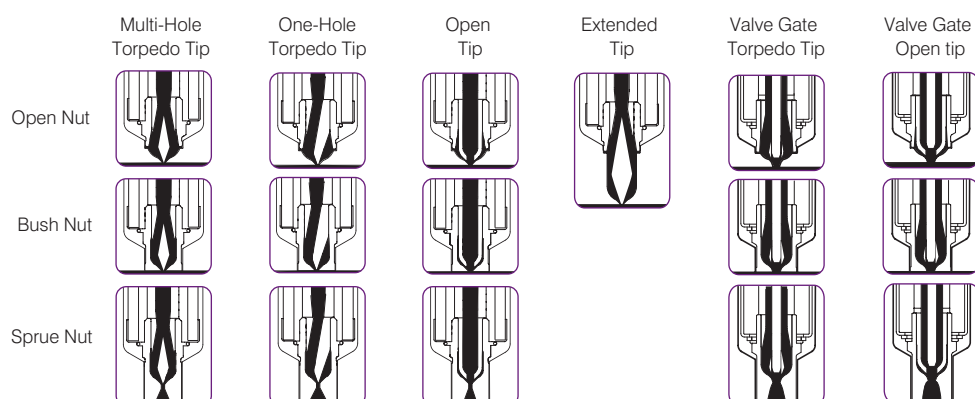

	13 Series	16 Series	19 Series	27 Series
L	45	45		
	55	55	55	
	65	65	65	
	75	75	75	75
	95	95	95	95
	115	115	115	115
	145	145	145	145
	175	175	175	175
				225
A	10	12	15	23
A/F	31	34	36	45
d2	34	38	40	50
d3	27	30	33	43
L4	12	12	15	20

All measurements are in millimetres

mastip™
hot runner solutions



Sporting an extremely compact design, the VeriShot™ system greatly reduces mold height requirements as it doubles as a locating ring housing the mechanics. This ensures perfect alignment between mold and machine platens.

VeriShot™ is compatible with TX16, TX19 and TX27 FlowLoc™ nozzles, which screw directly into the lower manifold providing a secure, leak-proof solution.

- Stainless Steel construction for maximum service life
- Reduced mould height at 54mm+ nozzles.
- Location ring can be sized to your requirement

Gating Options

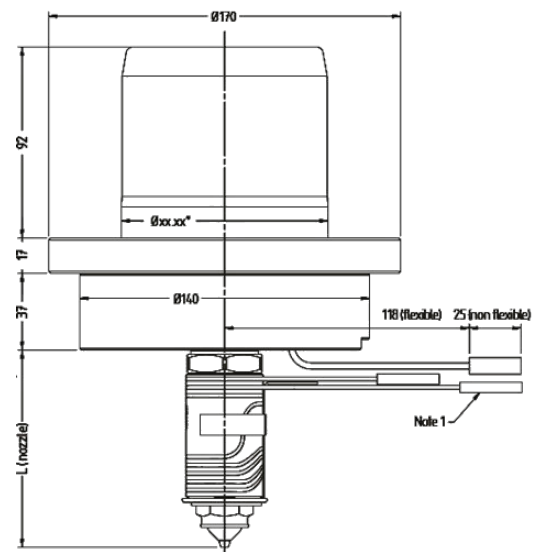
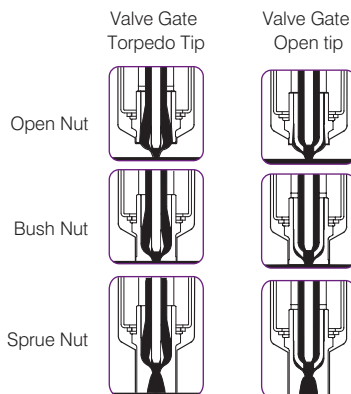

FlowLoc Nozzle Compatibility

	16 Series	19 Series	27 Series
L	75	75	75
	85	85	85
	95	95	95
	105	105	105
	115	115	115
	130	130	130
	145	145	145
	160	160	160
	175	175	175
	200	200	200
	—	225	225
	—	250	250
	—	275	275
	—	300	300
	—	—	350
	—	—	400
	—	—	450

Valve Gate Assembly

	16 Series	19 Series	27 Series
Model	SVG	SVG	SVG
Actuation Type	Pneumatic	Pneumatic	Pneumatic
Pin Size	2.5	3.0	5.0
Stroke	10	10	10

All measurements are in millimetres

mastip™
hot runner solutions

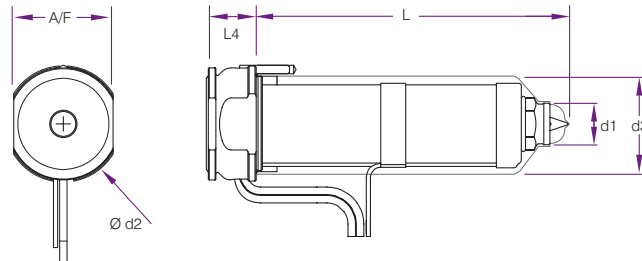
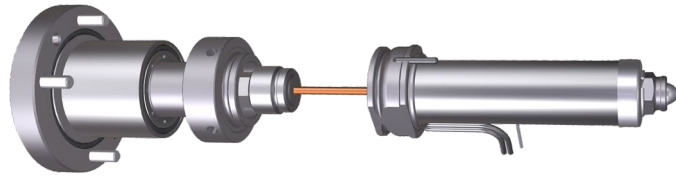

Gating Options

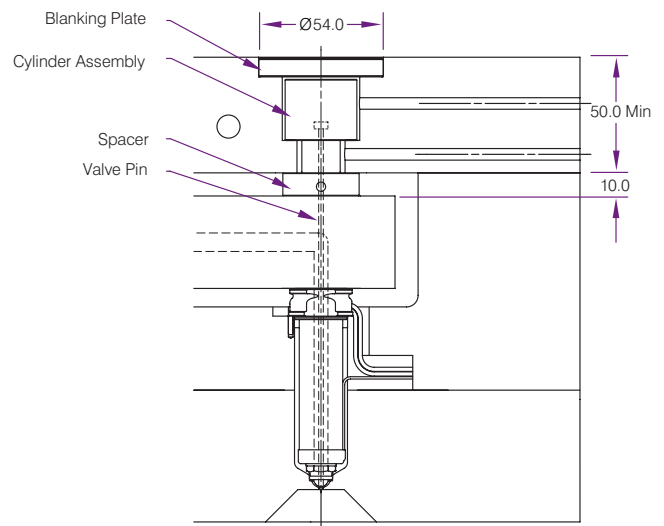
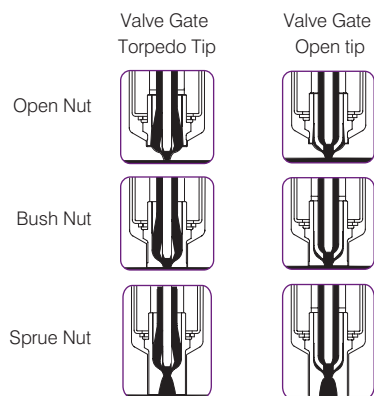

Valve Gate Assembly

	13 Series * MX / BX	16 Series MX / BX
Model	MVG25 - 2.0	MVG25 - 2.5
Actuation Type	Pneumatic	Pneumatic
Pin Size	2.0	2.5
Stroke	7	7

	13 Series		16 Series	
	MX	BX	MX	BX
L	45	45	45	45
	55	55	55	55
	65	65	65	65
	75	75	75	75
	95	95	95	95
	115	115	115	115
	145	145	145	145
	175	175	175	175
A/F	24	31	26	34
d1	10	10	12	12
d2	28	34	30	38
d3	22.9	27	24.9	30
L4	12	12	12	12

All measurements are in millimetres

* 13 Series available in open nut and open tip only



Manifold systems to suit all your moulding requirements

Mastip's experienced teams can design and manufacture manifold systems to suit all your moulding requirements. All Mastip manifolds are designed to deliver a uniform melt to each nozzle, ensuring cavity-to-cavity consistency. This is achieved through natural balancing of the flow channels and ensuring constant temperature profiles are maintained across the manifold block. Small cavity or high cavity systems, simple single level or complex multi-level stack systems, thermal gate or valve gate systems, Mastip can provide you with a Manifold system to meet your requirements in standard high quality mould base steel or stainless steel plates.

Scan this QR code to go to website for further information:



Standard Layouts, Exceptional Results

Mastip has an extensive range of standard or customized manifold designs that ensure cavity-to-cavity consistency through the normal or theological balancing of flow channels.

Each manifold incorporates durable, high quality components that deliver fast cycle times, precise gate control and superior quality parts.

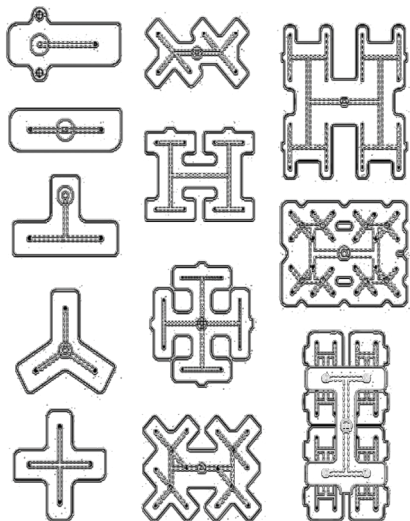

Durable, Long-lasting Components

All manifolds are equipped with superior components including pressed-in heaters, ceramic connectors and high quality mould base or stainless steel plates, enabling them to perform under the most demanding applications and conditions.

Mastip's manifold range is further complimented by the industry leading X-Range nozzles and the extensive range of tip and nut combinations to deliver high performing, durable solutions able to meet the demands of the most abrasive and difficult to mould resins.

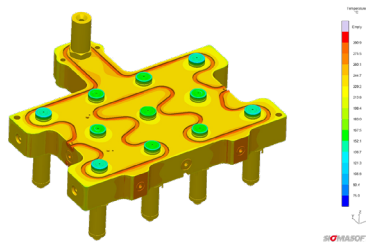

Designed, Manufactured and Tested

Every manifold goes through extensive design and analysis to ensure the following:

- optimised melt delivery
- improved production efficiencies
- perfect cavity-to-cavity filling
- excellent gate quality

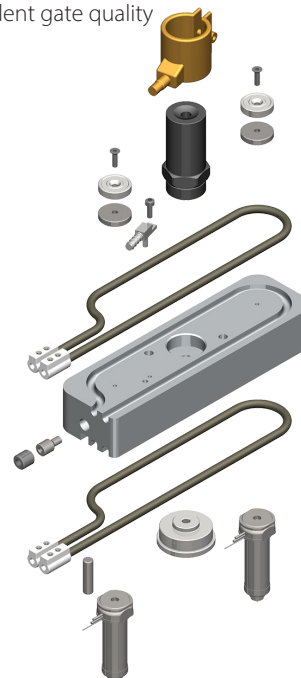

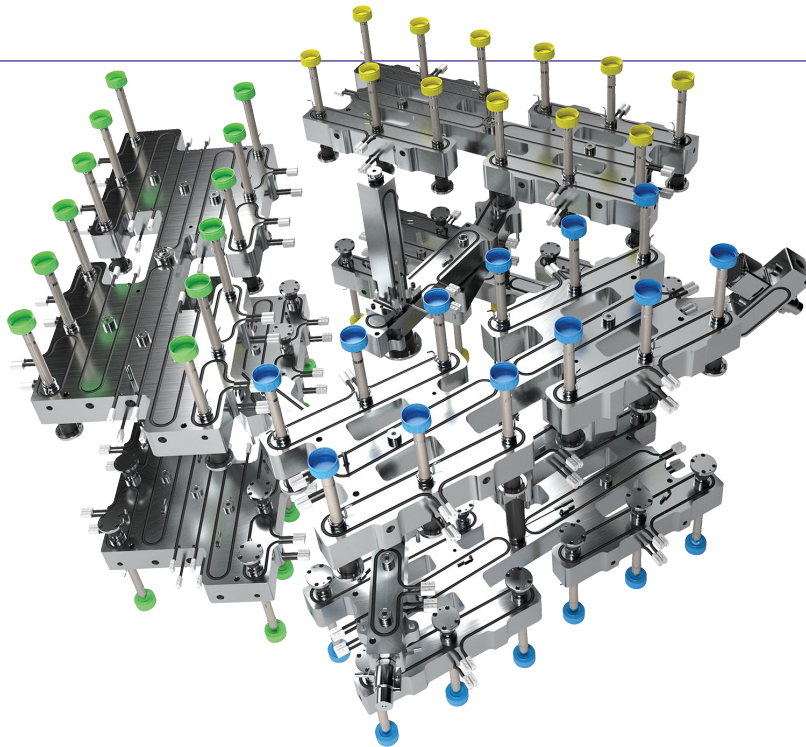

High cavity single or multi-level systems

Mastip's expert teams can design and manufacture high cavity single or multi-level systems, with thermal or valve gates. Our systems are designed and manufactured to the highest level of quality, delivering a uniform melt to each nozzle, ensuring cavity-to-cavity consistency. This is achieved through natural balancing of the flow channels and ensuring constant temperature profiles are maintained across the manifold block. Mastip can provide you with a Manifold system to meet your requirements in standard high quality mould base steel or stainless steel plates.

Scan this QR code to go to website for further information:



Designed, Manufactured and Tested

Every high-cavity manifold goes through extensive design and analysis to ensure the following:

- optimise melt delivery
- balanced cavity-to-cavity filling
- excellent gate quality
- optimise thermal profile

Incorporating M-Series Multi-Cavity Nozzles

Specifically designed for multi-cavity systems, the MX and MJ nozzle series are simple to install, front-loading for ease of servicing and ideal for close-pitch gating due to small gate pocket requirements.

MX and MJ nozzles have superior thermal insulation and precise temperature control to optimise cycle times and are available in sizes ranging from 45-175 mm.

Guaranteed to Perform

Mastip Hot Half systems are backed by a 3 year leak-proof guarantee, available in thermal or valve gate configurations and delivered as a complete solution to integrate seamlessly into your mould.

Include a Meticom Temperature Controller with your Hot Half System order and we will extend the warranty on the Mastip Hot Half System from 3 to 5 years.

See page 10 for more information

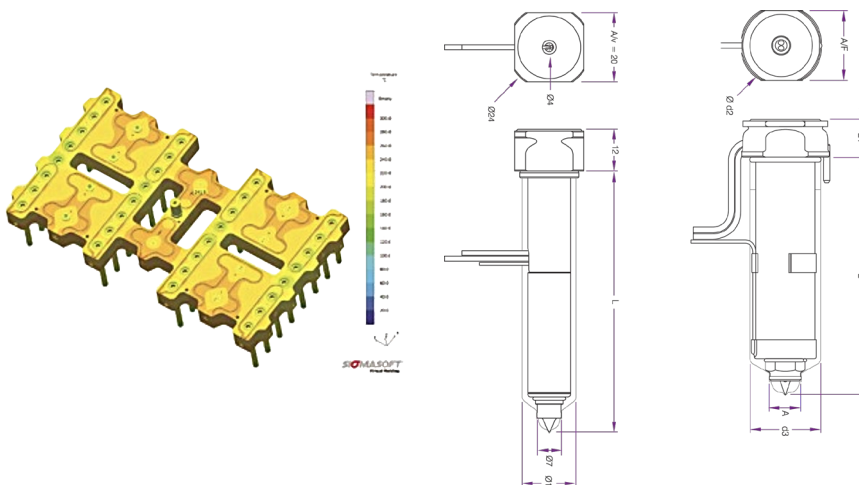

mastip™
hot runner solutions

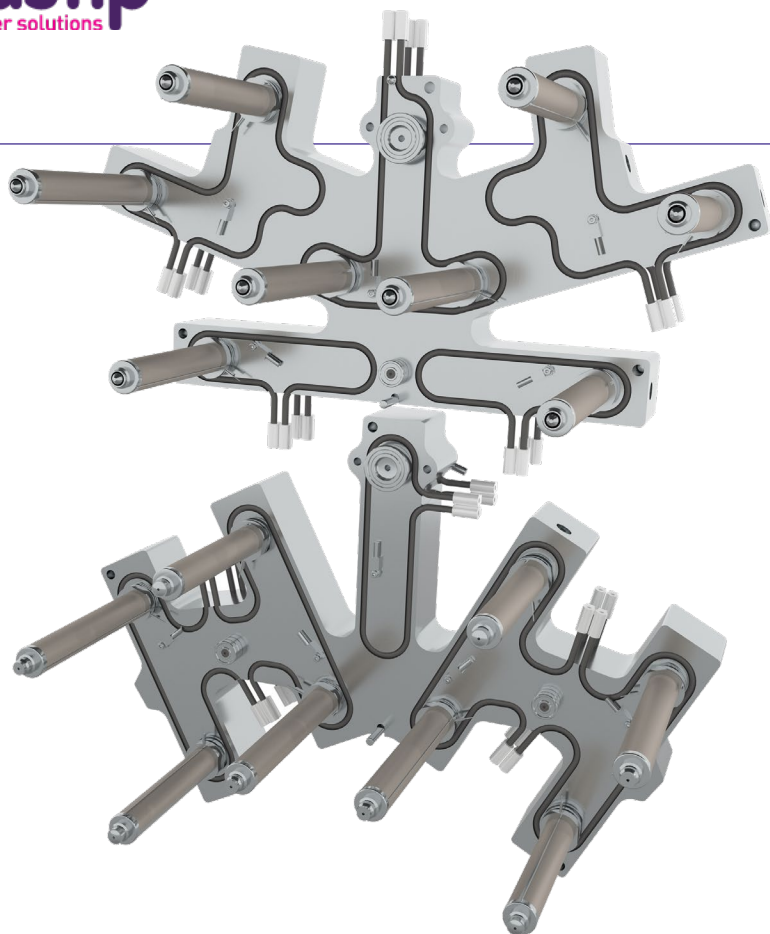

From Simple to Technically Advanced Multi-Material Systems

Mastip has extensive experience in supplying solutions for multi-material and multi-colour applications. Whether it is over moulding soft grips or different colours on single part, Mastip has the technology and technical expertise to develop the right multi-material hot runner solution for your needs. From simple high cavity plastic packaging to technically advanced components such as structural and engineering parts for the automotive industry, incorporating Mastip's multi-material systems into your mould can simplify your production, deliver quality parts and save you time and money on your product assembly.

Scan this QR code to go to website for further information.



Unique Designs for Multi-Component Moulding

Multi-material moulding is a common way to create parts with two or more types of material in order to provide stability, functionality or aesthetic appeal over traditional single type material parts. Common examples of this include razor and toothbrush handle grips.

Often referred to as multi-shot, co-injection or over-moulding, multi-material solutions are typically uniquely designed systems providing an effective and cost-efficient way to produce custom parts requiring multiple types of material or colours in a single mould.

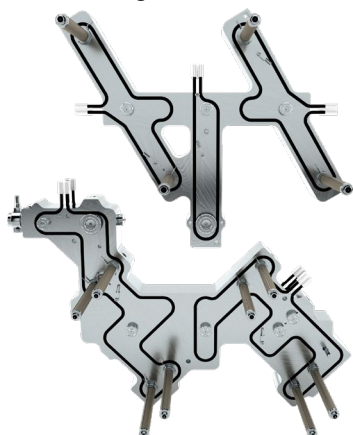

Designed, Tested and Supported

Mastip works closely with our customers to design customised solutions that solve their unique requirements for multi-material moulding.

Each system is supplied with installation and mould recommendations and backed by our global service and support network.

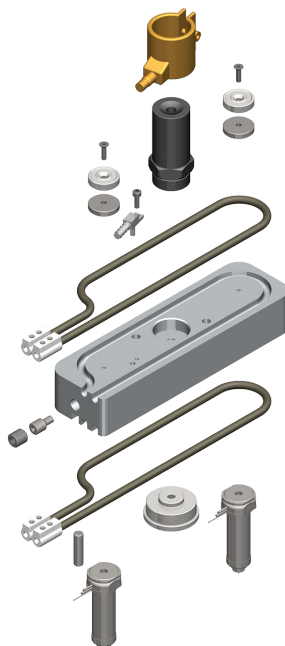

Durable, Long-lasting Components

All manifolds are equipped with superior components including pressed-in heaters, ceramic connectors and high quality mould base or stainless steel plates, enabling them to perform under the most demanding applications and conditions.

Mastip's manifold range is further complimented by the industry leading X-Range nozzles and the extensive range of tip and nut combinations to deliver high performing, durable solutions able to meet the demands of the most abrasive and difficult to mould resins.



mastip™
hot runner solutions

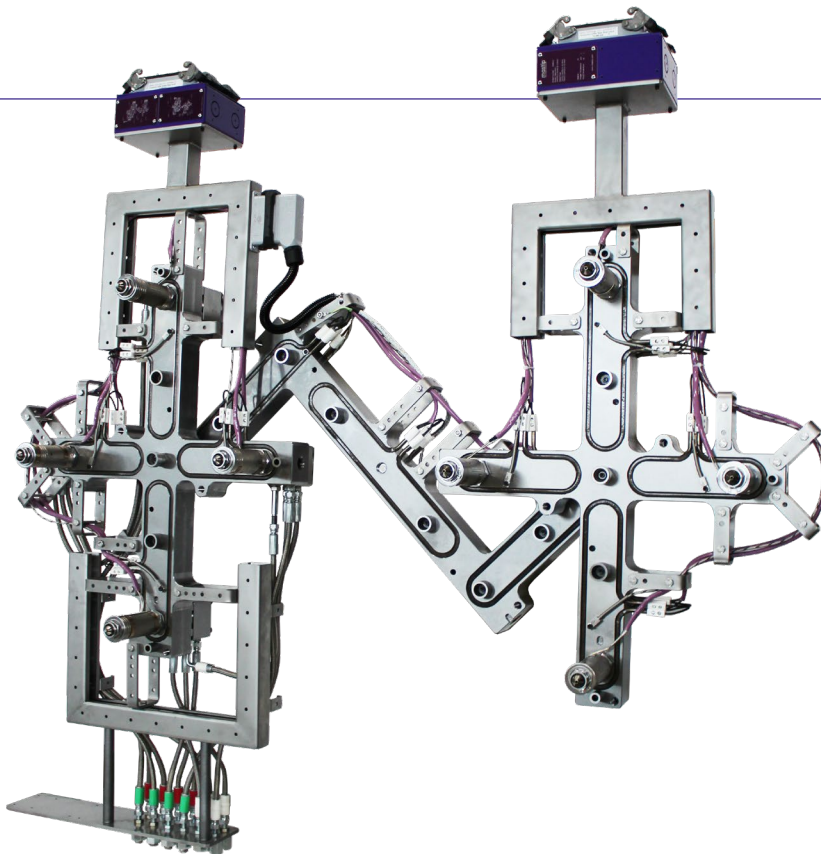

Ready ▶ Set ▶ Inject

Following on from the ground breaking success of Mastip's Nexus Thermal Gate we are proud to introduce the **Nexus Valve Gate with Cylix actuation.**

Mastip's next generation Nexus™ Systems are delivered Pre-Assembled and Pre-Wired as a complete turn-key solution for quick and simple installation.

Both the Nexus Thermal Gate and the Nexus Valve Gate Systems incorporate the advanced leak protection of FlowLoc™ Technology.

Scan this QR code to go to website for further information

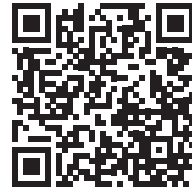

Nexus™ systems are designed for fast, simple installation out of the box without requiring any further assembly

Nexus™ systems feature fully customisable frames, electrical connections, tip and nut options and nozzle lengths to suit your application requirements.

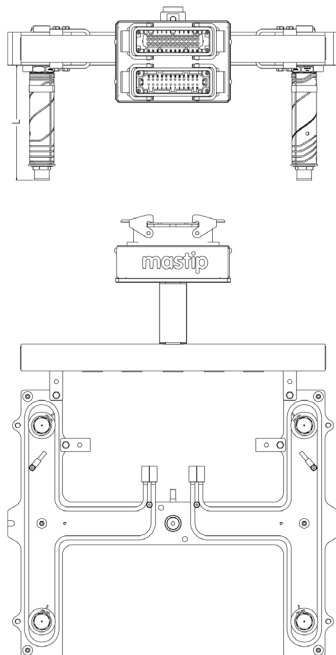

Cylix™ Valve Gate Actuation

The Cylix™ Cylinder features Pneumatic Valve actuation in a thermally stabilized system mounted directly to the manifold. With the ability to adjust valve pin height and incorporating long life seals and bearings, it is the optimal solution for precise control of your moulding requirements.

Nexus™ System with FlowLoc™ Nozzle

The FlowLoc nozzle range features a threaded base that attaches to the manifold providing a secure, leak-proof operation. With advanced heating technology, the FlowLoc delivers superior thermal performance for a wide moulding window

All measurements are in millimetres.
*** Further nozzle lengths are available on request**

